



SPLITTER GEARBOX SZ 118/154



Splitter gearbox SZ mounted in a frame bracket, permits the assembly of double pumps on the same power take off.

Splitter gearbox SZ provides unlimited freedom to combine pumps with different size flows.

Splitter gearbox SZ is available with gear ratio 1:1.18 or 1:1.54 which gives a corresponding reduction in pump size or additional flow.

Other advantages of splitter gearbox SZ:

- Suitable for all Sunfab pumps with DIN flange.
- Can be mounted horizontally or vertically.

Type		SZ 118	SZ 154
Gear ratio		1:1.18	1:1.54
Max. continuously input torque	ft-lb	516	516
Max intermittent input torque	ft-lb	737	737
Max continuously torque/pump output	ft-lb	221	170
Max intermittent torque/pump output	ft-lb	310	236
Weight	lb	27.12	27.12
Lubrication oil, intermittent operation	gal	0.13	0.13

Subject to design alteration

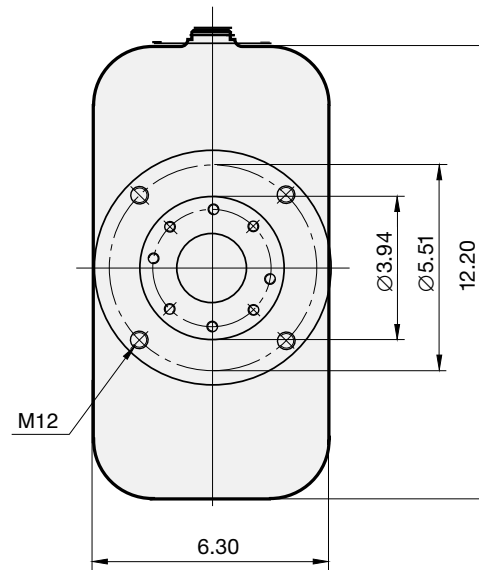
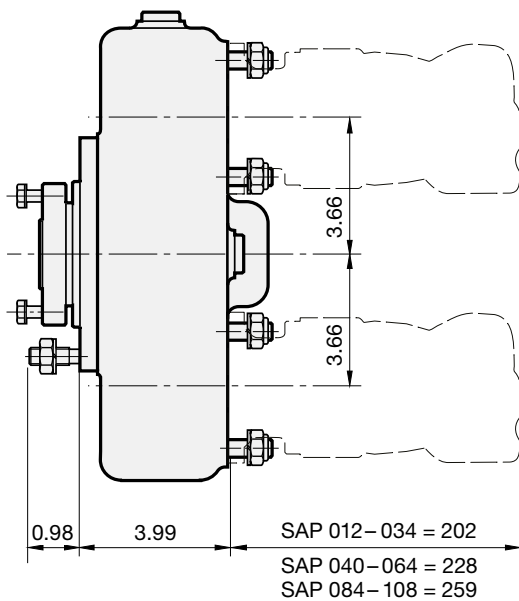

With intermittent operation the gearbox should be filled with 0.13 gal of hypoid oil. Circulation lubrication is required with continuous operation to ensure cooling.

Intermediate shaft connection

The flange for the drive shaft fits directly on Spicer 1300 (B2). Adaptation for other drive shafts is done using the adapter flange, see SUNFAB's accessory catalogue.

The gearbox can also be equipped with an outgoing intermediate shaft on an optional pump output. An adapter is required for this. For component parts see the accessory catalogue.

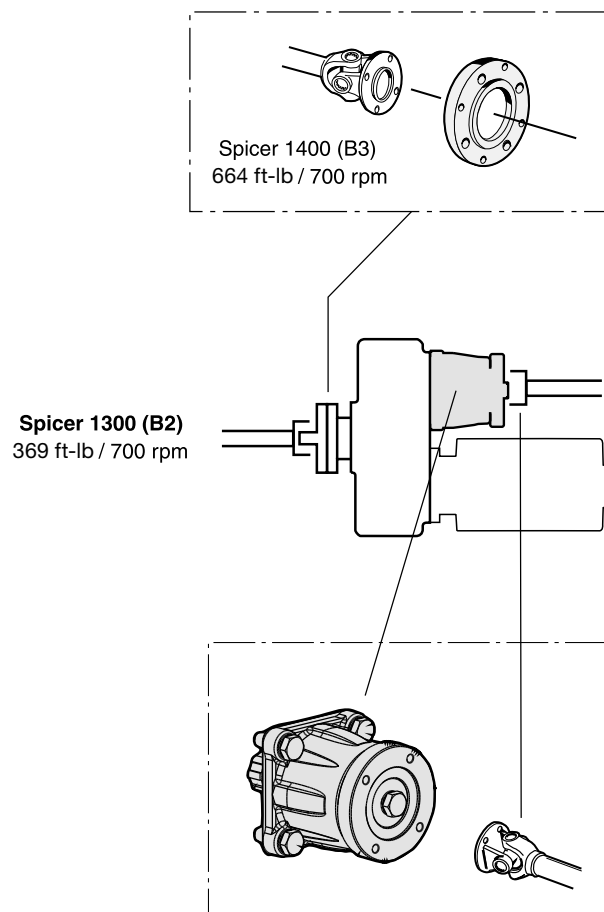

Sunfab reserves the right to make changes in design and dimensions without notice. Printing and typesetting errors reserved.

© Copyright 2022 Sunfab Hydraulics AB. All Rights Reserved.